

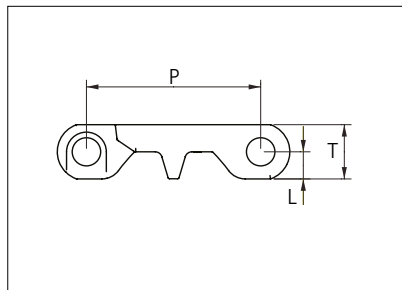

Plastic Modular Belt

Series **uni MPB** Type **25% Open**



Straight running belt
 Nominal pitch: 50.8 mm (2.00 in)
 Surface type: Flat
 Surface opening: 25%
 Backflex radius: 65.0 mm (2.6 in)
 Pin diameter: 8.0 mm (0.31 in)

Belt material & color	POM-DI W	PP W B	PE-I N	PE-I B	mm	in	T	mm	in
Pin material & color	PP W		PE W	PE B	L	8.0	0.31	-	-

Non standard material and color: See uni Material and Color Overview.

Belt width		Permissible tensile force (Belt/pin material)						Belt weight (Belt/pin material)						*Min No drive sprocket per haft	Number of wear strips (min no)	
		POM-DI/PP		PP/PP		PE-I/PE		POM-DI/PP		PP/PP		PE-I/PE			**Carry (pcs)	**Return (pcs)
mm	in	N	lbf	N	lbf	N	lbf	Kg/m	lb/ft	Kg/m	lb/ft	Kg/m	lb/ft			
152	6.0	4180	940	2432	547	1976	444	1.6	1.05	1.1	0.74	1.2	0.78	2	2	2
202	8.0	5555	1249	3232	727	2626	590	2.1	1.40	1.5	0.98	1.5	1.03	2	2	2
252	9.9	6930	1558	4032	906	3276	736	2.6	1.74	1.8	1.22	1.9	1.29	2	2	2
303	11.9	8333	1873	4848	1090	3939	885	3.1	2.10	2.2	1.47	2.3	1.55	3	3	2
353	13.9	9708	2182	5648	1270	4589	1032	3.6	2.44	2.5	1.71	2.7	1.80	3	3	2
403	15.9	11083	2491	6448	1450	5239	1178	4.2	2.79	2.9	1.95	3.1	2.06	3	3	2
454	17.9	12485	2807	7264	1633	5902	1327	4.7	3.14	3.3	2.20	3.5	2.32	4	4	2
504	19.8	13860	3116	8064	1813	6552	1473	5.2	3.49	3.6	2.44	3.8	2.57	4	4	2
554	21.8	15235	3425	8864	1993	7202	1619	5.7	3.83	4.0	2.68	4.2	2.83	4	4	2
605	23.8	16638	3740	9680	2176	7865	1768	6.2	4.19	4.4	2.93	4.6	3.09	5	5	3
655	25.8	18013	4049	10480	2356	8515	1914	6.7	4.53	4.7	3.17	5.0	3.35	5	5	3
705	27.8	19388	4358	11280	2536	9165	2060	7.3	4.88	5.1	3.41	5.4	3.60	5	5	3
756	29.8	20790	4674	12096	2719	9828	2209	7.8	5.23	5.4	3.66	5.7	3.86	6	6	3
806	31.7	22165	4983	12896	2899	10478	2355	8.3	5.58	5.8	3.90	6.1	4.12	6	6	3
856	33.7	23540	5292	13696	3079	11128	2502	8.8	5.93	6.2	4.14	6.5	4.37	6	6	3
907	35.7	24943	5607	14512	3262	11791	2651	9.3	6.28	6.5	4.39	6.9	4.63	7	7	4
957	37.7	26318	5916	15312	3442	12441	2797	9.9	6.62	6.9	4.63	7.3	4.89	7	7	4

Additional standard belt widths are available in steps of 50.3 mm (1.98 in). Additional non-standard belt widths are available in steps of 16.8 mm (0.66 in).

1964	77.3	54010	12141	31424	7064	25532	5740	20.2	13.60	14.1	9.50	14.9	10.03	14	14	7
------	------	-------	-------	-------	------	-------	------	------	-------	------	------	------	-------	----	----	---

Additional standard belt widths are available in steps of 50.3 mm (1.98 in). Additional non-standard belt widths are available in steps of 16.8 mm (0.66 in).

2971	117.0	81703	18367	47536	10686	38623	8682	30.6	20.57	21.4	14.38	22.6	15.17	20	20	10
------	-------	-------	-------	-------	-------	-------	------	------	-------	------	-------	------	-------	----	----	----

General belt tolerance is +0/-0.4% at 23°C/73°F. For exact belt width contact Customer Service. Non standard belt width on request.

*Max. Load per Drive Sprocket. Belt material: POM-DI/PP/PE-I with snub roller 2000 N (450 lbf) without snub roller 1250 N (281 lbf).

**Max. Spacing between wear strips, Carry: 152.0 mm (6.00 in); Return: 304.0 mm (12.00 in).

= Single Link



STANDARD

STRAIGHT RUNNING

PITCH 50.8 MM/2.00 IN

Accessories

Flight

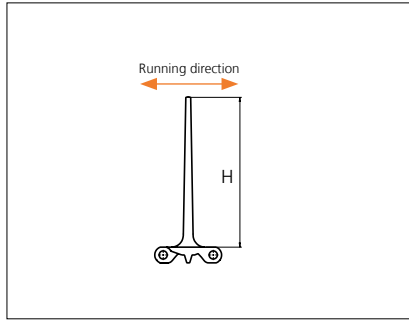
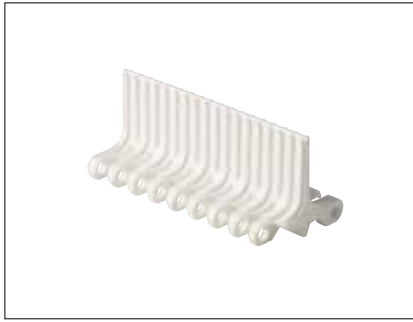

Type	Material & color	H		Link size	Width		Indent both sides	
		mm	in		mm	in	mm	in
10% Non Stick	PP-I W B N	50.8	2.00	K600	151.0	5.94	0.0	0.00
		76.2	3.00					
		101.6	4.00					

For more options: See separate uni MPB series Flight datasheet.

Accessories

Flight

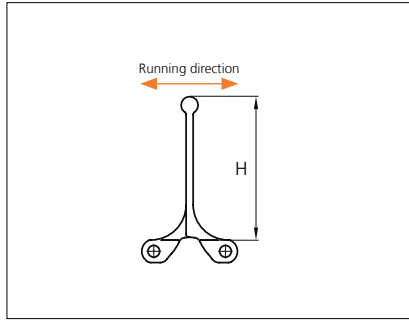
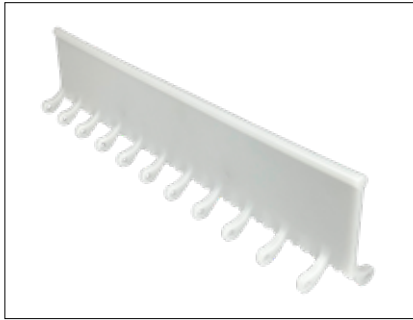

Type	Material & color	H		Link size	Width		Indent both sides	
		mm	in		mm	in	mm	in
Flat Round Bar	PE-I B N	101.6	4.00	K1520*	385.9	15.19	0.0	0.00
				K2120**	537.1	21.15		

*Designed to fit K1800 belt with 34.0 mm (1.34 in) indents.

**Designed to fit K2400 belt with 34.0 mm (1.34 in) indents.

Note: Possible indents in steps of 16.9 mm (0.68 in).

Note: By using this flight the belt loses 33% of its permissible tensile force.

Accessories

Side Guard

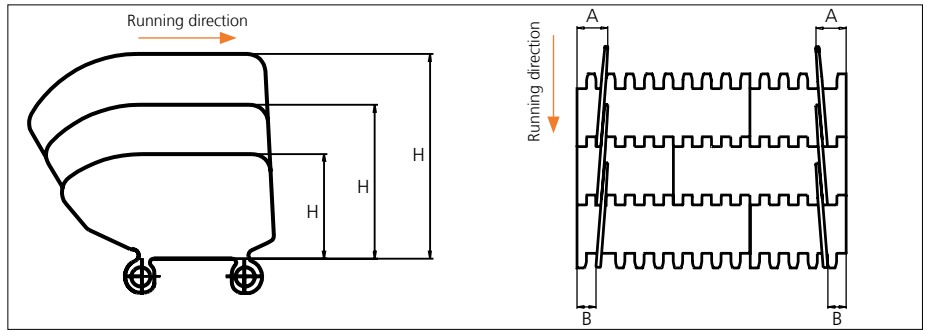

Type	Side Guard Material & color	H		A		B	
		mm	in	mm	in	mm	in
Closed	PP-I W B N	50.8	2.00	32.0	1.26	16.0	0.63
		76.2	3.00				
		101.6	4.00				

*34.0 mm (1.34 in) combined with flight. Increment: 8.4 mm (0.33 in).

Note: Backflex radius when Side Guard are used: 200.0 mm (7.90 in).

Accessories

Tab

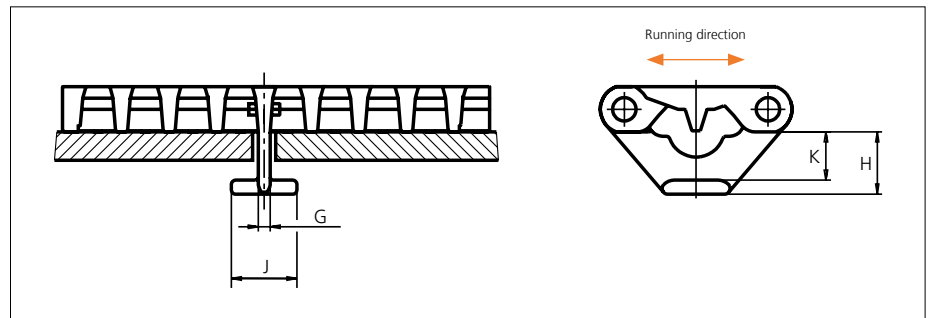

Type	Tab Material & color	G		J		K		H	
		mm	in	mm	in	mm	in	mm	in
Bottom Hold Down	POM-DI W	4.2	0.17	23.2	0.91	17.0	0.67	22.0	0.87

Note: When using tabs, please verify sufficient clearance to the shaft. Max. shaft diameter = Sprocket pitch diameter - 63.5 mm (2.50 in). When using square shafts, please verify that the diagonal does not exceed max. diameter. Example: Sprocket z = 6: Max. shaft diameter 101.6 - 63.5 = \varnothing 38.1 mm (4.00 - 2.50 = \varnothing 1.4 in).

Note: When using a belt system with tabs, the temperature should be constant. Please note that the tabs are not always placed in the middle of the belt.

Non Standard material and color: See uni Material and Color Overview.

Accessories

Non standard uni AmFlight

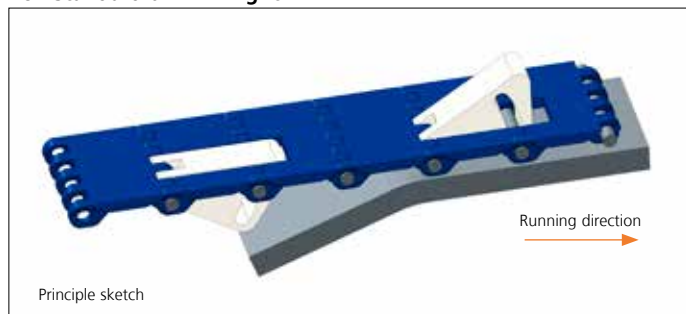

Other non standard option: See uni Amflight Overview.

